

**DET. 1 - BANCOS**  
ESC. 1:25

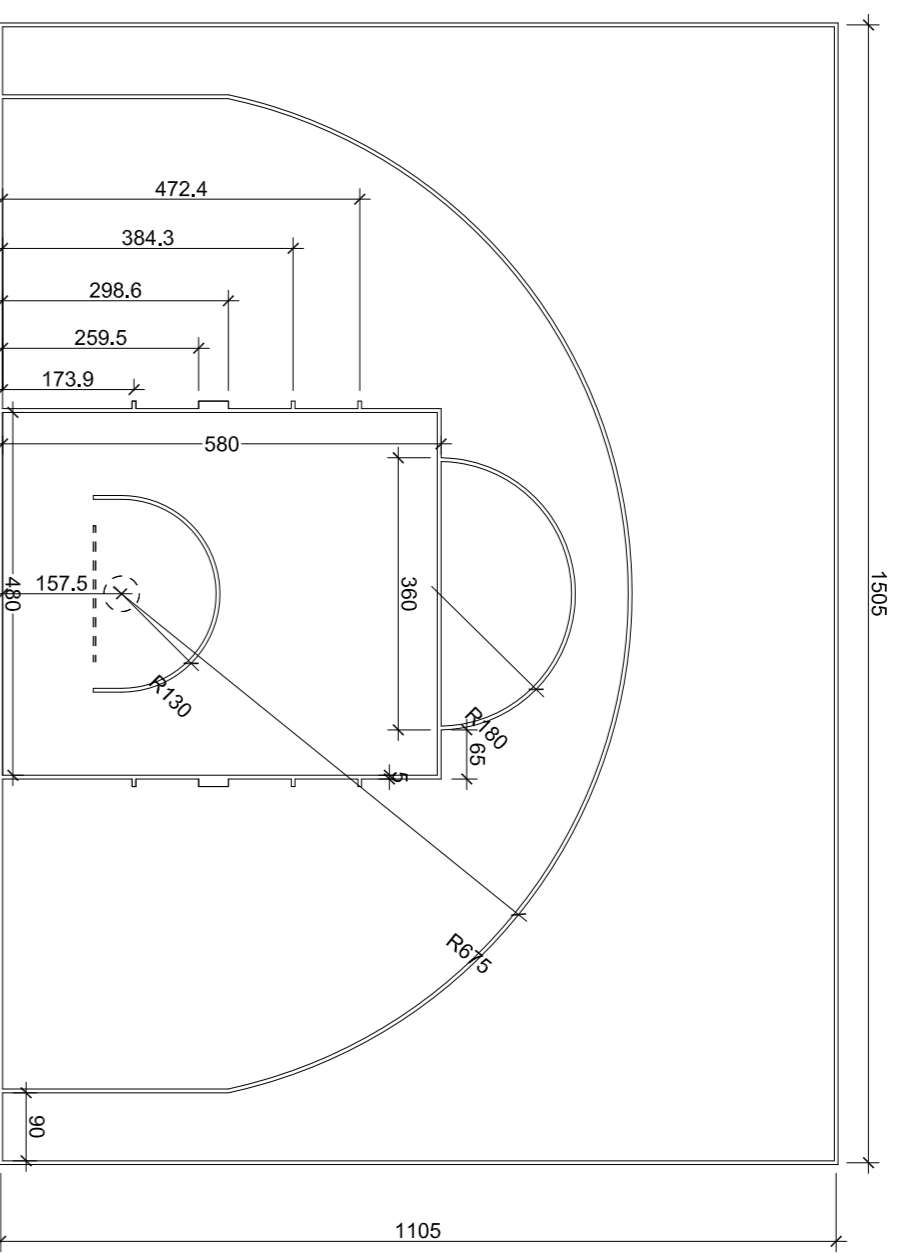

**DET. 2 - QUADRA DE BASQUETE**  
ESC. 1:100

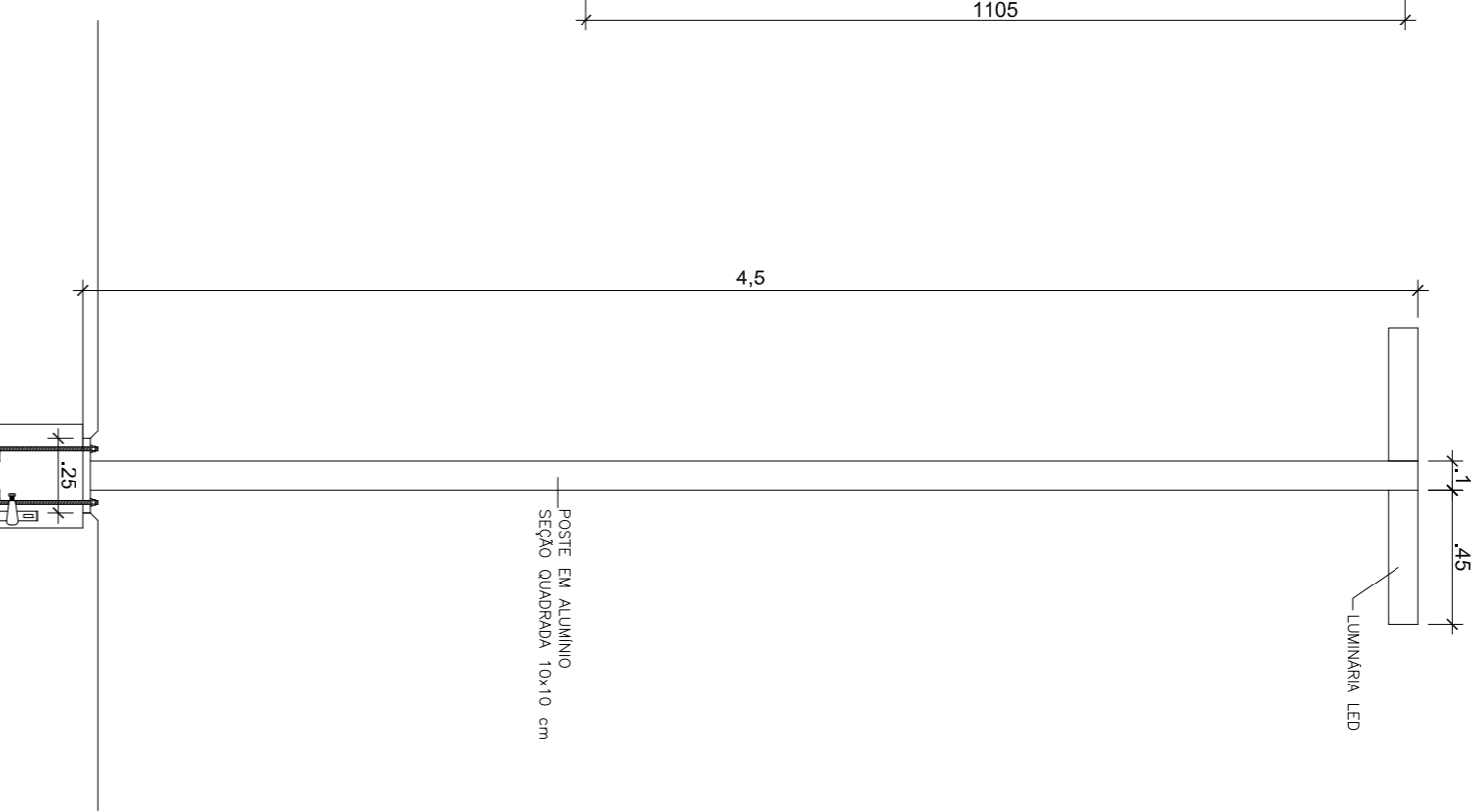

**DET. 6 - LUMINÁRIA DUPLA**  
ESC. 1:25

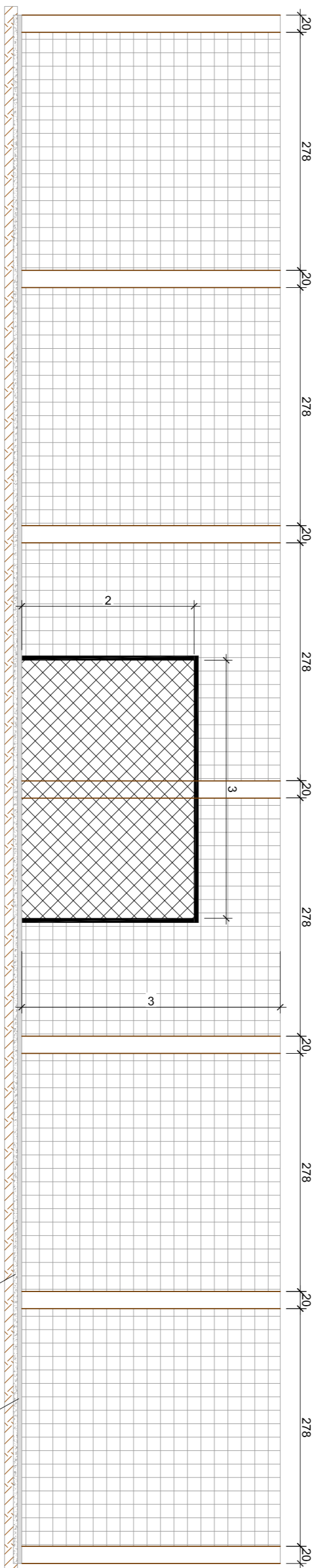

**DET. 3 - ALAMBRADO QUADRA DE FUTEBOL**  
ESC. 1:50

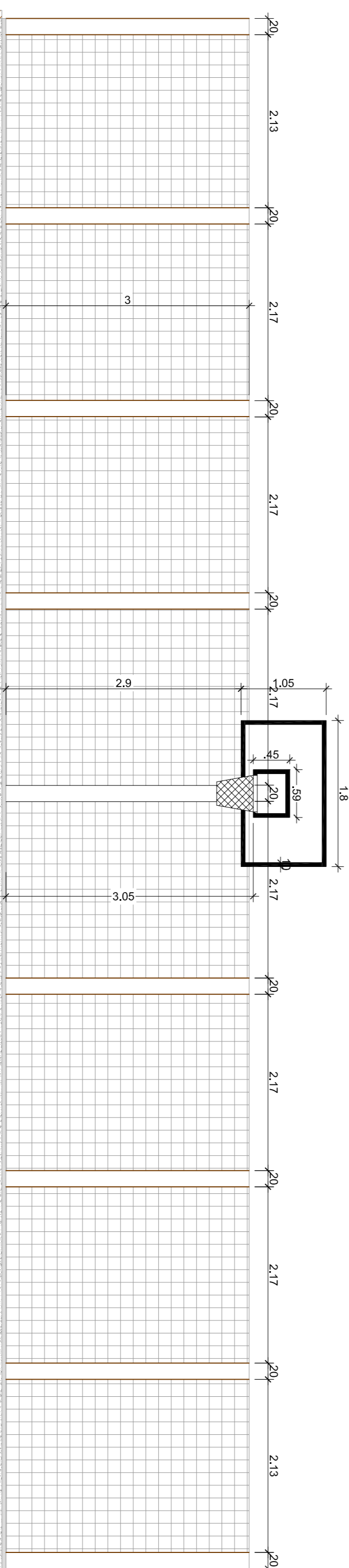

**DET. 4 - ALAMBRADO QUADRA DE BASQUETE**  
ESC. 1:50

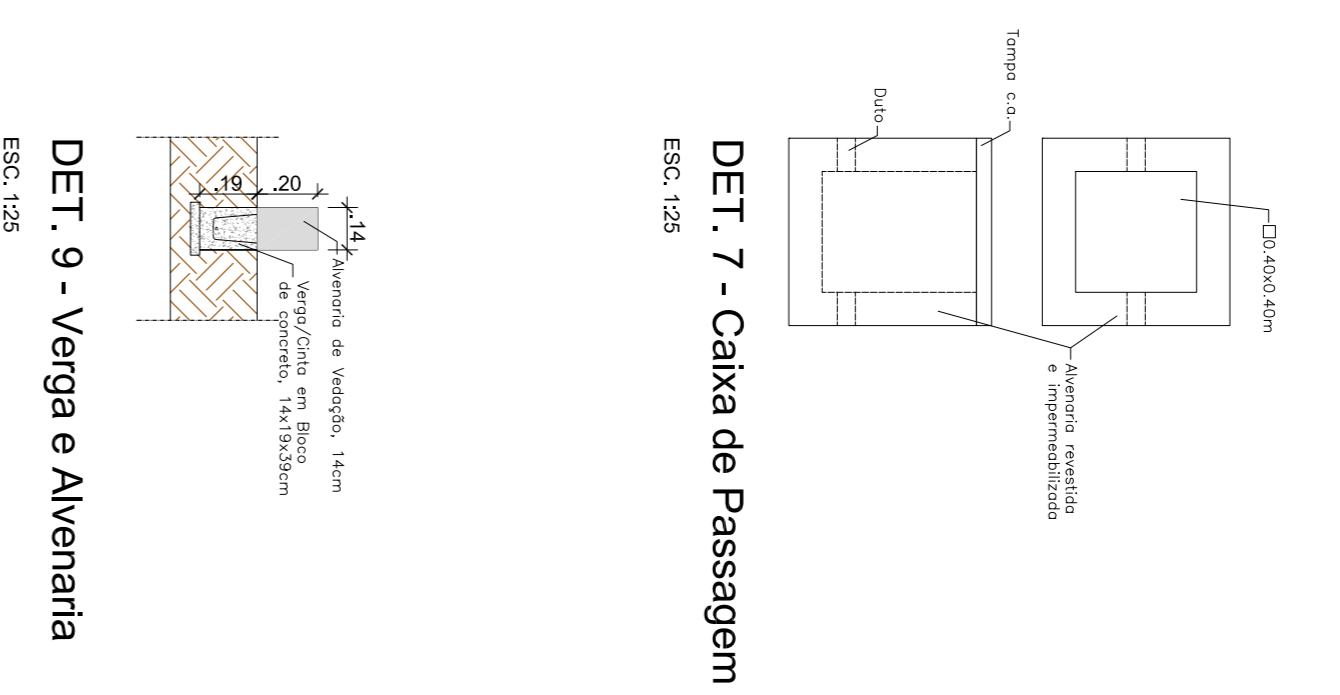

**DET. 7 - Caixa de Passagem**  
ESC. 1:25

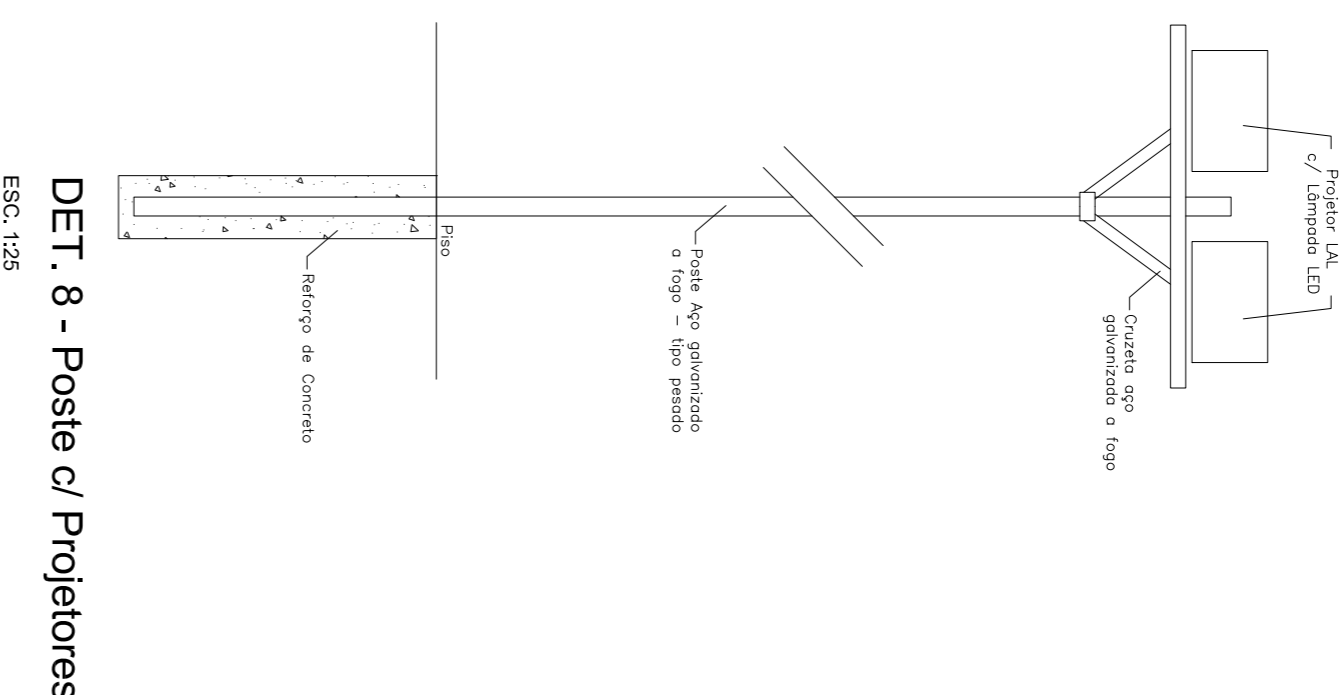

**DET. 8 - Poste c/ Projetores**  
ESC. 1:25

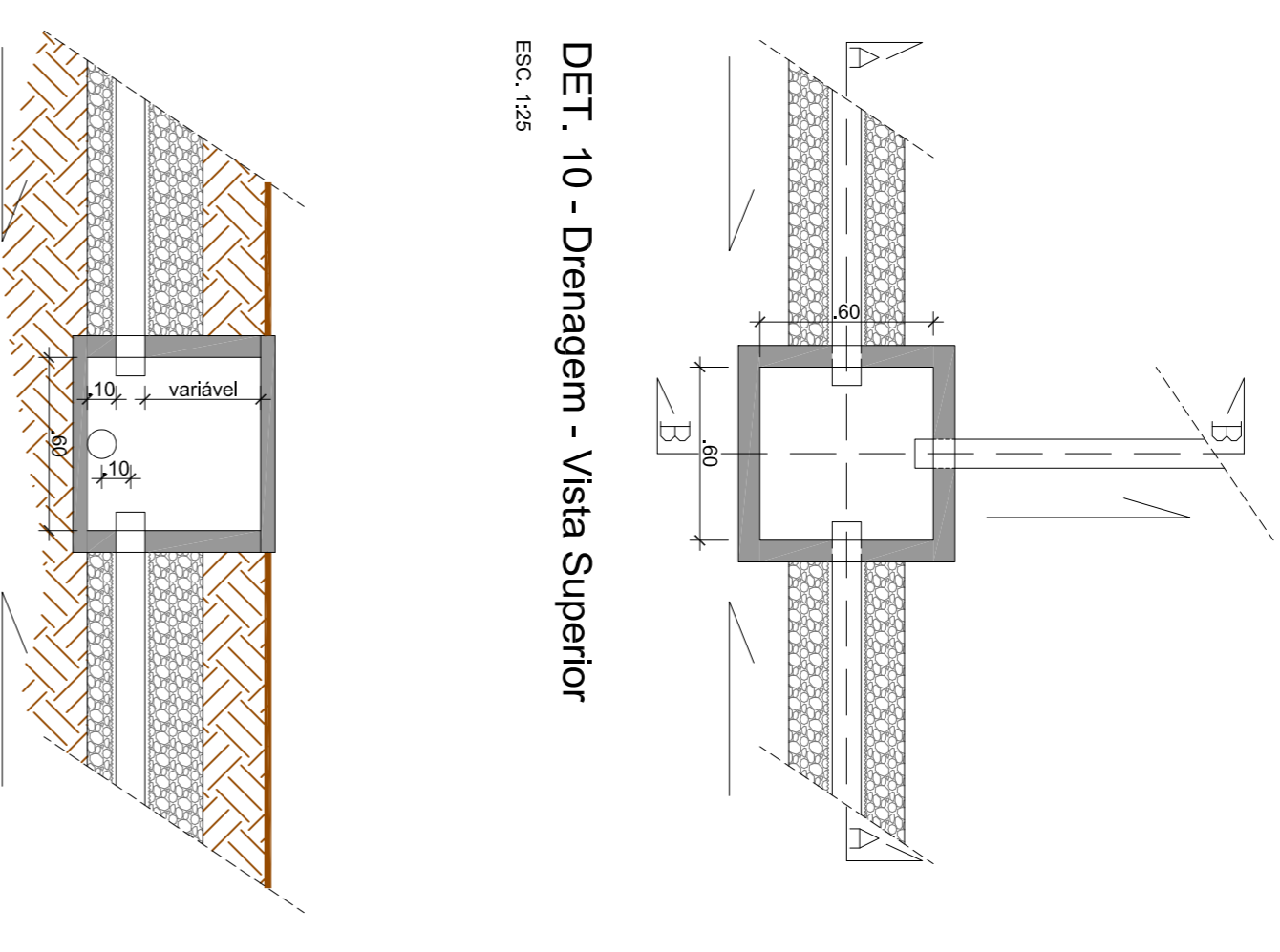

**DET. 10 - Drenagem - Vista Superior**  
ESC. 1:25

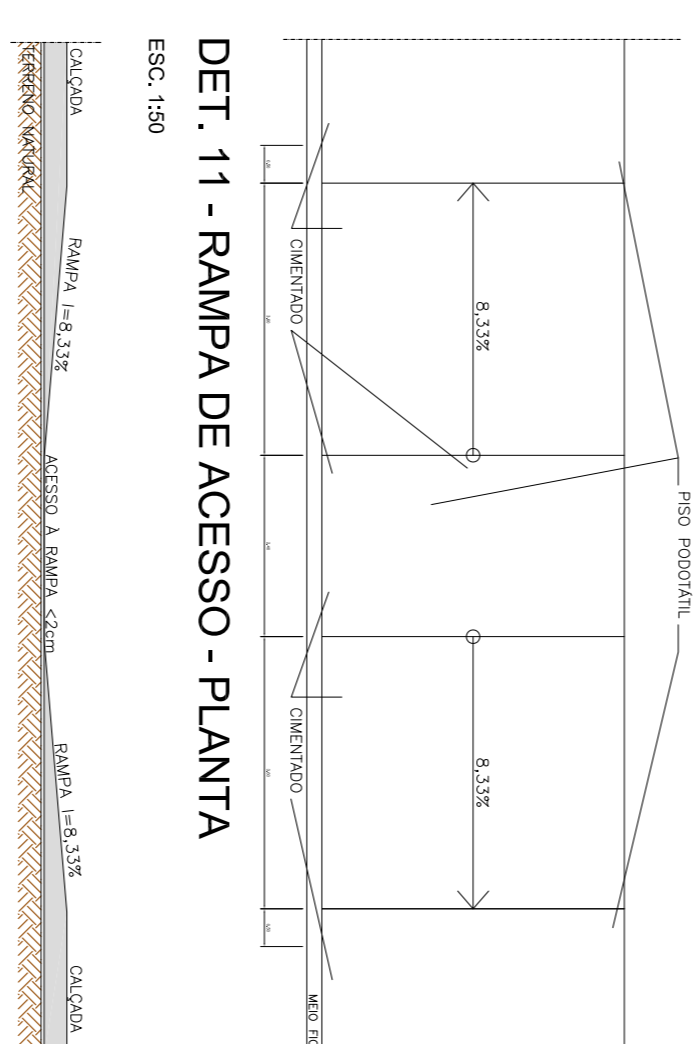

**DET. 11 - RAMPA DE ACESSO - PLANTA**  
ESC. 1:50

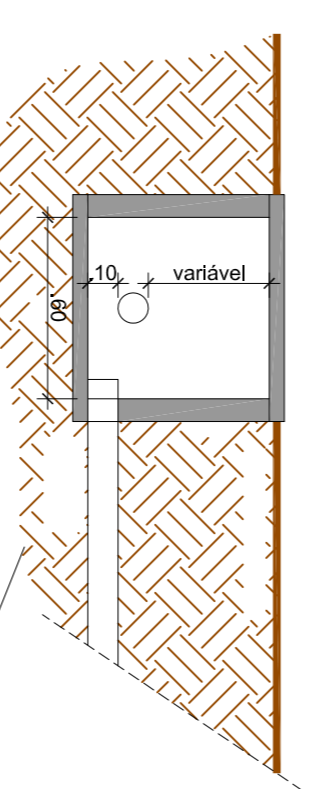

**DET. 10 - Drenagem - Seção BB**  
ESC. 1:25

**DET. 11 - RAMPA DE ACESSO - CORTE**  
ESC. 1:50

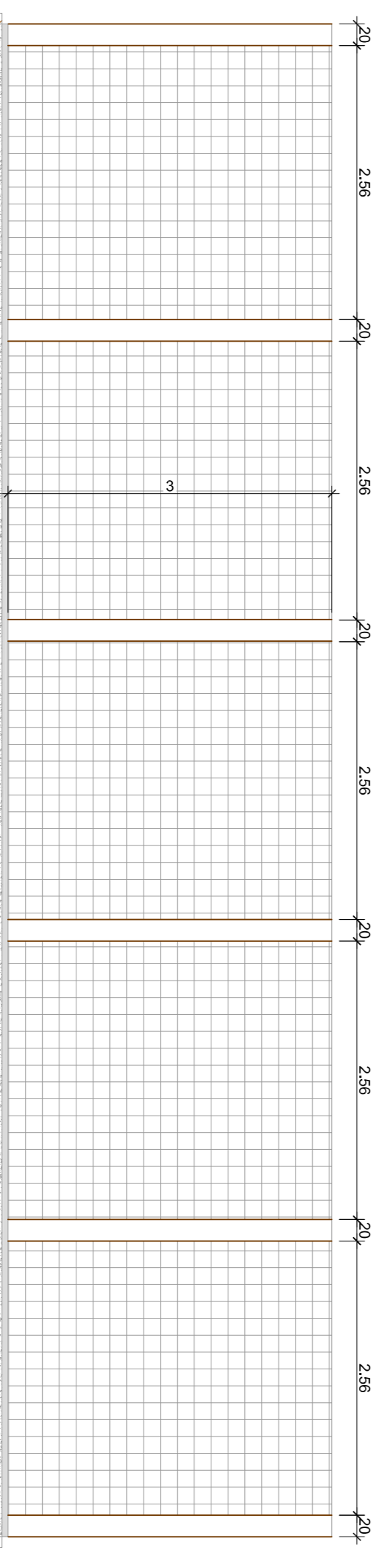

**DET. 5 - ALAMBRADO QUADRA DE VOLEI**  
ESC. 1:50

N°	DATA	REVISÃO	RESPONSÁVEL

PROJETADO POR:  
 DES.: CAROLINE VAZ  
 PROJ.: CAROLINE VAZ  
 DES.: CAROLINE VAZ  
 ASS.: CAROLINE VAZ  
 CAD.: AY2611-7  
 FEV/2017

MUNICÍPIO DE ILHA COMPRIDA  
 ESTANÇIA BALNEÁRIA  
 AVENIDA BEIRA MAR 11000 - CEP 11925-000

OBRA: ILHA DE LAZER  
 BALNEÁRIO CTR MAR  
 ASSINTE: DE TALHES GERARIS

N° DES.	PL.	REV.	DATA
001			
002			
003			

03/03
00
INDICADA